



WVPL-5000

SERIES

ISHIDA High Speed Weigh-Price-Labeler



Easiest to use, compact machine for high speed lines!

New! Ishida High-Speed Weigh-Price Labeler



Ease of use

GUI and color touch panel provides user friendly operation. No complicated training and no mistakes for any operator.

color touch panel

The 10.4-inch color touch panel provides easy operation even for unskilled operators.

visual eye-con

Smooth operation is visually enhanced with error messages that are displayed along with eye-con.



label formatting screen



WYSIWYG at label formatting provides less programming time and no label waste.

Data management capability

Built in Ethernet on WPL-5000 ensures that throughput can be monitored in real time, both by local supervisors and at operations headquarters. Live operation data enables simultaneous production control adjustment.

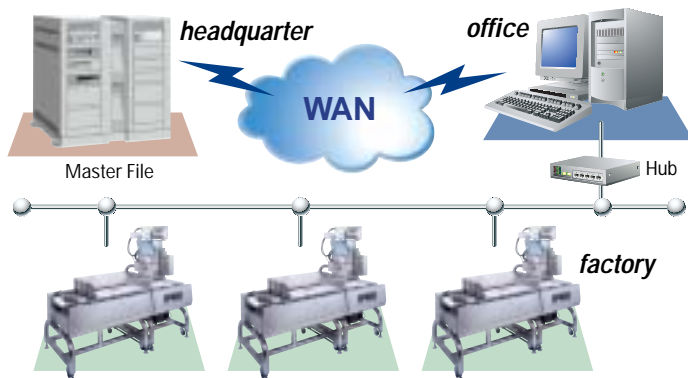

remote diagnosis



Monitoring and remote diagnosis assist preventive maintenance and prompt corrective action. Moreover, because all errors are logged, data can be analyzed to maintain WPL-5000 at highest performance.

Product information can easily be revised and entered from the office.

up dating



Product information can easily be revised and entered from the office.

Minimization of down time

Side guide and printer moves to proper position automatically in accordance with called up PLU.

No more down time for adjusting the guide and the printer for small quantity but many different kind of product.

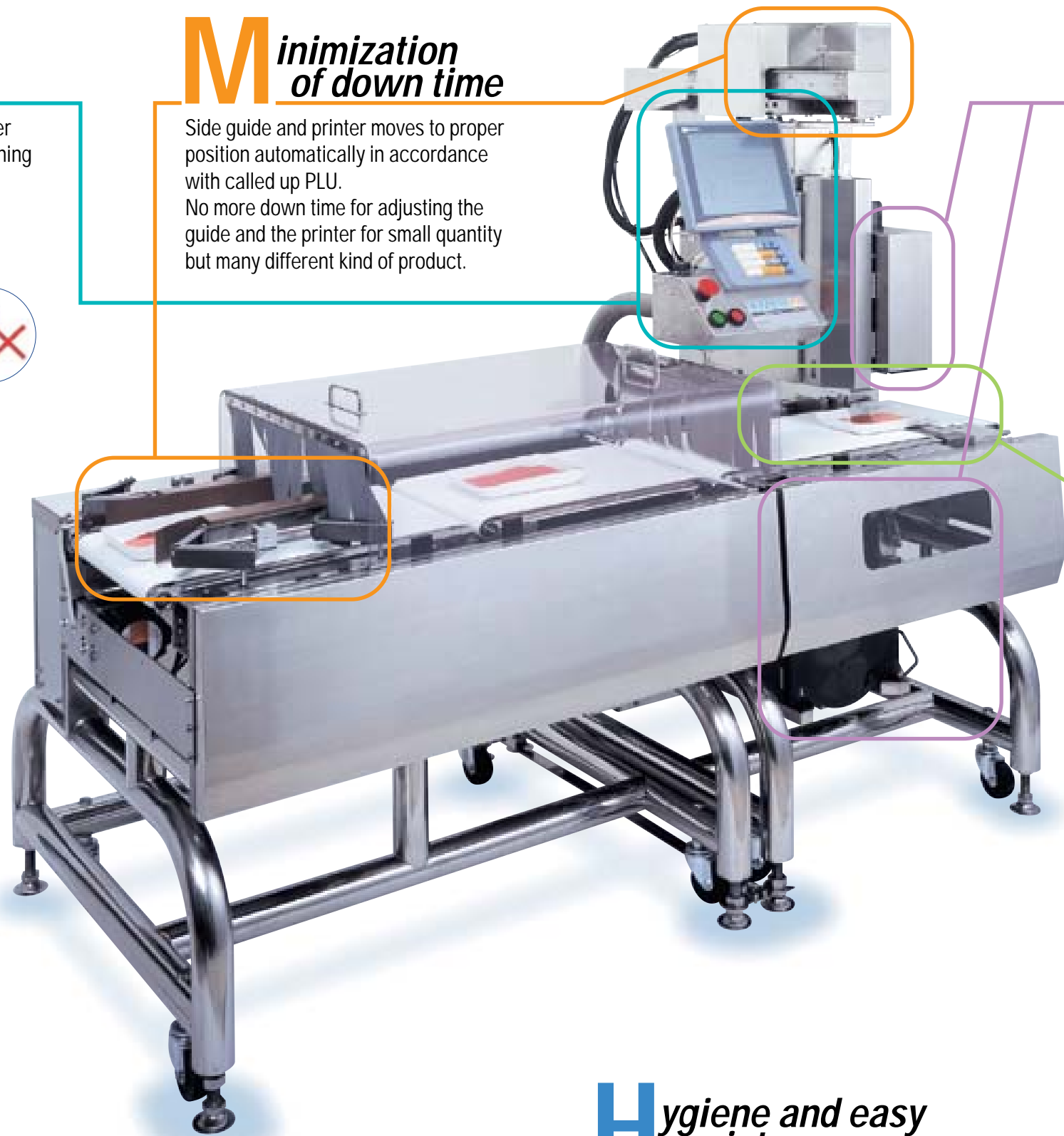

Label cassette

Minimum label switch over enables to improve operator efficiency. What is more, same cassette can be used either way up or under printer.

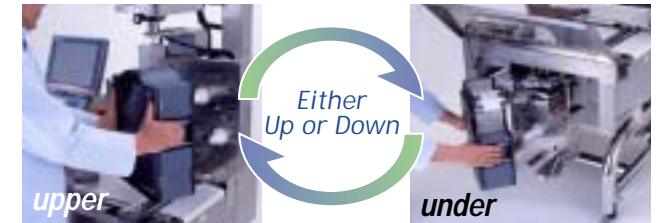

Accurate and flexible labelling

It provides High-speed (max. speed 255mm/sec or nearly 10 inch/sec) label printing with even odd shape labels or rounded small flush labels.



• Automatic printing angle: 0°-180° in 15° increments

top surface labels



9 air cylinder arms realize very accurate label placement at high speed, even more for odd shape products!

under labeller



After application, a blast of air ensures that, even on undersides of convex tray packages, labels are properly and neatly attach.

Hygiene and easy maintenance access

Each detachment/replacement with no tools for cleaning or washing of the conveyor. Hygiene steel stainless construction for all surface of machine. State-of-the-art design pipe stand prevent machine from accumulation of proceed food or other dust, meat piece.



label formatting software

Optional PC software provides you simple and easy revision from the office.



Specifications

Model	WPL-5000
Capacity /min. Display	4 kg / 2 g , 2 kg / 1 g
Display	10, 4 " color touch display
Product tray size	Length 65 mm to 410 mm, Width 40 mm to 300 mm, Height 15 mm to 150 mm.
Conveyor speed	Variable
Label size	Upper labeler, (Cassette) Width 20 mm to 85 mm , Length 20 mm to 150 mm (non Cassette) Width 20 mm to 100 mm, Length 20 mm to 150 mm Under labeler, (Cassette) Width 20 mm to 85 mm , Length 28 mm to 100 mm
Label roll	Core θ 76 mm, Outside θ 230 mm (Cassette) θ 300 mm (non Cassette)
Printing speed	MAX 255 mm / sec
Resolution	8 dot / mm
Label applicator	Air jet, Air cylinder jet, Air cylinder arm.
Bar code variants	EAN / UPC 8, EAN / UPC 13, EAN / UPC 128, CDE 128, ITF, PDF 417.
Interface	TCP / IP (1 ch), RS232C (4 ch), I2NET (2 ch)
Memory	Expandable CF card memory up to 32MB
Power Rating	AC100 V to 240 V \pm 10% 50 / 60 Hz
Air supply	0.5 Mpa
Operating temperature	-5 $^{\circ}$ C to 40 $^{\circ}$ C
Humidity	20-80 % RH, non-condensing

Dimensions unit: mm (inch)

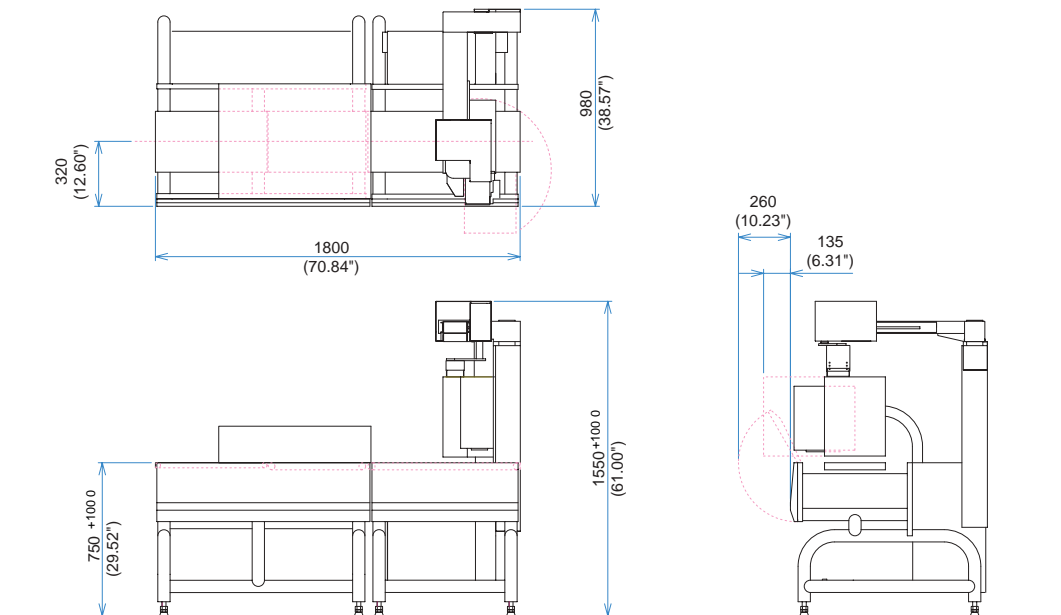

ISHIDA CO., LTD.

44 SANNO-CHO, SHOGOIN, SAKYO-KU
KYOTO, 606-8392 JAPAN
PHONE : 81-75-771-4141
FACSIMILE: 81-75-751-1634
URL: <http://www.ishidajapan.com>

Specifications subject to change without notice



Proudly Sold & Serviced By:

Able Scale Co Pty Ltd

Ph: 1300 731 360

21 Green St Thomastown VIC. 3074

find us on the web: www.ablescale.com.au